

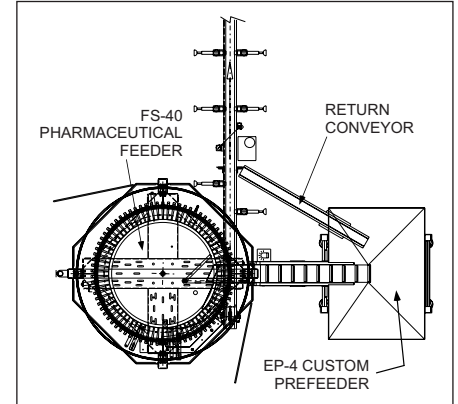

**Product Overview:**

The Shibuya Hoppmann FS-40 Pharmaceutical Feeder is designed to feed and orient pharmaceutical style bottles and cylinders with the use of urethane scallops. Parts are radially oriented and gently qualified in the scallop pockets by means of sweeps, wipers, pneumatic and/or electric devices depending on specific product characteristics. Oriented parts are discharged and carried away by various downstream in-line devices.

**Application Example**



**Standard Features:**

- All stainless steel exterior construction
- FDA/USDA approved heavy gauge ABS plastic disc
- Teflon hard-coated finished aluminum bowl pre-drilled for scallop mounting
- Air clutch
- Backup Ring
- Platform style tooling
- Panel mount controller card

**Available Options:**

- Washdown motor(s)
- NEMA 1 encased controller

\*Scallops - please contact Shibuya Hoppmann for more information.

Part Number	VFS401RPDPA	VFS401RPAPA
Motor Style	DC	AC
Motor Voltage	90V	230/460V
Horsepower	1/2hp	1/2hp

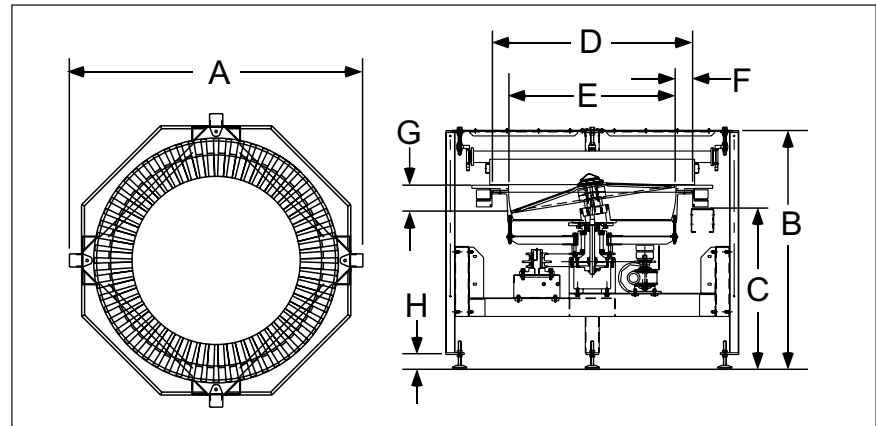

Product Specifications		ANSI	Metric
A	Outside Diameter	65"	1651mm
B	Frame Height	48.50"	1232mm
C	Discharge Height	36"	914mm
D	Bowl Outside Diameter	43.46"	1104mm
E	Bowl Inside Diameter	36.25"	921mm
F	Rim Width	3.61"	92mm
G	Bowl Depth	5.95"	152mm
H	Level Foot Adjustment	5" ± 2.5"	127 ± 64mm

**Headquarters**  
13129 Airpark Dr.  
Suite 120  
Elkwood, VA 22718  
540.829.2564 t  
800.368.3582 t  
540.829.1726 f

**Sales Office**  
1445 Brookville Way  
Suite F  
Indianapolis, IN 46239  
317.322.0754 t  
800.368.3582 t  
317.322.0794 f

**Manufacturing Office**  
291 Dillard Road  
Madison Heights, VA  
24572  
434.929.4746 t  
800.543.0915 t  
434.929.4959 f

www.ShibuyaHoppmann.com | sales@ShibuyaHoppmann.com

Shibuya Hoppmann Corporation strives to improve its products and reserves the right to change or discontinue specifications & designs shown in this brochure without notice and without incurring obligation. Revised: 12/11.